

Duct Design: Sound Silencers P-173

Design of Special Silencer solution for Sound Attenuating in ducting System with both low and high velocity for

- Power Plants
- Waste Incineration Plants
- Sludge Incineration Plant
- Steel Mills
- Commercial Buildings

P-Engineering Designs:

- Absorption Baffle Attenuators
- Helmholtz Silencer
- Quarter Wave Attenuators
- Bespoken SRV Silencers

Furthermore, P-Engineering designs divider Plates for removing Flow induced 'von Karmen' Vortex in Tube Bundles in Boilers.

The design work includes detailed design including e.g.:

- Baffle Design
- Duct/Frame Design
- Flexible Joint Design
- Manufacturing drawings for Support, Ducting and Baffles
- Sound Attenuating Curves in 1/1 Octave 63-8k Hz

P-Engineering does also Sound Insulation Specifications for Large Ducting – rectangular and Circular including ring-frequency adoption as well Sound Proofing e.g., Axial Flow Fans and Centrifugal Fans.

Contact Information:

Christian Pallesen; +45 2526 8805; cp@p-engineering.dk

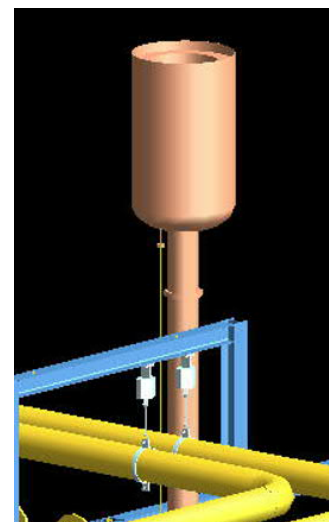
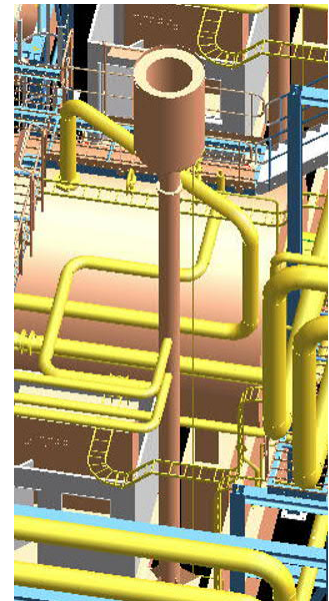

Bespoken Safety and Blow Out Silencer for a Power Plant in Scotland for Aker Solution (UK)

Christian Pallesen through employment in Burmeister & Wain Energy in the 1990'ties designed sound attenuator solutions for several power plant project:

Skærbækværket Unit 3 (N-Gas fired):

- SA-Fan Up- & Downstream (Absorption Baffles)
- FGD-Fan Up- & Downstream (Absorption Baffles)
- ID-Fan Up- & Downstream (Absorption Baffles)

Nordjyllandsværket Unit 3 (Coal fired):

- SA-Fan Up- & Downstream (Absorption Baffles)
- PA-Fan Up- & Downstream (Absorption Baffles)
- FGD-Fan Up- & Downstream (Absorption Baffles)
- ID-Fan Up- & Downstream (Absorption Baffles)

Avedøreværket Unit 2 (Coal, Wood Chips, Oilemulsion fired):

- SA-Fan Up- & Downstream (Absorption Baffles)
- PA-Fan Up- & Downstream (Absorption Baffles)
- FGD-Fan Up- & Downstream (Absorption Baffles)

Stignæsværket Unit 2 (Coal fired) – Chiyoda FGD-plant

- ID-Fan Up- & Downstream (Absorption Baffles)

Endstedværket Blok 3 (Refurnished for Biomass):

- SA-Fan Up- & Downstream (Absorption Baffles)
- PA-Fan Up- & Downstream (Absorption Baffles)
- FGD-Fan Up- & Downstream (Absorption Baffles)
- ID-Fan Up- & Downstream (Absorption Baffles)

KARA (Waste Incineration)

- SA-Fan Up- & Downstream (Absorption Baffles)
- PA-Fan Up- & Downstream (Absorption Baffles)

Svanemølleværket (CCGT)

Exhaust Silencer (Combined Absorption and Helmholtz).

Viborg KVV (CCGT)

Exhaust Silencer (Combined Absorption and Helmholtz).

Asnæsværket Unit 2 (Coal fired):

Flow Induced Vibrations (Helmholtz Damper)

Store Enzo; Hyllabruk (SE) (N-Gas fired):

Flow Induced Vibrations (Helmholtz Damper)